

Stays



Product range:

Box Stays
Duo Stays
Flap Stays
Lid Stays
Lift & Slide
Lift & Swing
Lift and Fold
Maxi Stays
Senso Stays
Strato Stays
Verso Stays

Lift & Fold Stay

Lift & Fold system for the space-saving folding of top cupboard doors

Permits the easy opening and closing of horizontal folding doors with just one movement. The pressure brake produces a very simple and uniform movement

One-handed operation

Centre hinge has a unique finger/hand anti trap function

An extremely wide opening of the flap allows optimum and unhindered use of the cupboard interior

Suitable for wooden and aluminium framed doors

Suitable for different door weights from 5kg-16.2kg

Lifting arms for 3 different door heights 555mm, 720mm and 800mm

Larger width doors would need 3 centre hinges, depending on the weight and length of the doors a third arm maybe required

Minimum depth of cabinet required 280mm

When calculating the door weight please include the handle

720mm High Cabinet

UST 3672-720-06	5.3-6.5kg	
UST 3672-721-06	6.6-8.7kg	
UST 3672-722-06	8.8-11.0kg	
UST 3672-725-06	6.6-8.7kg	3 Hinge
UST 3672-726-06	8.8-11.0kg	3 Hinge
UST 3672-820-06	5.3-6.5kg	2 Arm
UST 3672-821-06	3.3-4.4kg	1 Arm
UST 3672-822-06	6.6-8.7kg	2 Arm

555mm-589mm High Cabinets

UST 3672-801-06	3.5-5.4kg	1 Arm
UST 3672-802-06	7-8kg	2 Arm
UST 3672-803-06	4-5kg	1 Arm
UST 3672-804-06	8.1-10kg	2 Arm
UST 3672-805-06	5-6.5kg	1 Arm

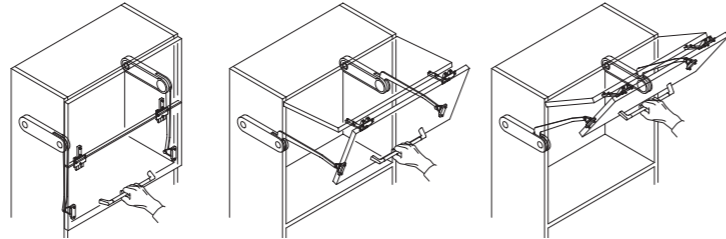
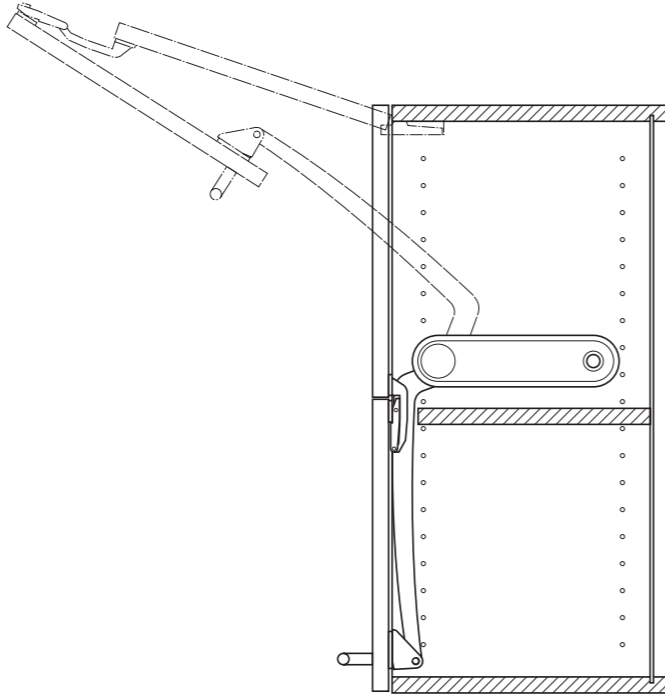

Lift & Slide Stay

The Lift & Slide mechanism allows a smooth and effortless open and closing of the door in just one movement

The door stays in any set position allowing the user to reach the door handle easily

The Lift & Slide mechanism is available for cabinet heights from 350mm to 660mm, and cabinet lengths from 600 to 1200mm wide

The Lift & Slide mechanisms are available for cabinet with door weights from 3.6kg to14.6kg

The Lift & Slide mechanism can be adjusted three dimensionally

Minimum depth of cabinet required 280mm

When calculating the door weight please include the handle

380-500mm Door

UST 3679-121-06	4.8-6.0kg
UST 3679-122-06	6.1-7.6kg
UST 3679-124-06	9.9-11.0kg
UST 3679-125-06	11.5-14.6kg

450-580mm Door

UST 3679-150-06	4.7-5.9kg
------------------------	-----------

Fixing Brackets

UST 3679-000-61	Pairs
------------------------	-------

Stabilising Rod

UST 3679-113-06	1200mm
UST 3679-537-06	600mm
UST 3679-837-06	900mm

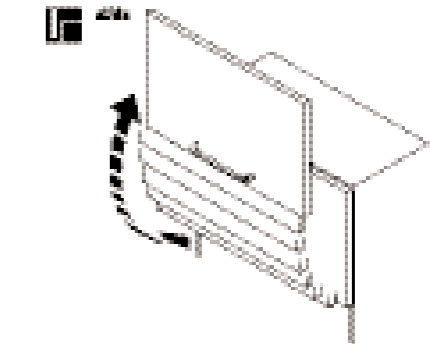
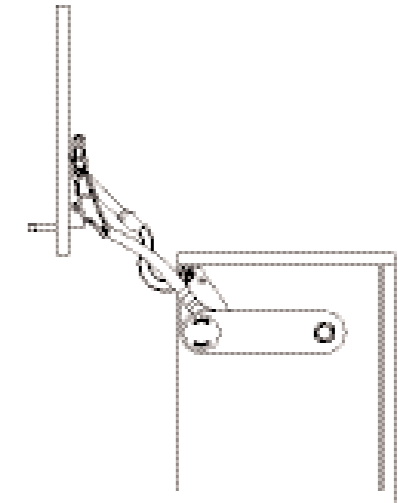

Lift & Swing Stay

The Lift & Swing mechanism allows a smooth and effortless open and closing of the door over the carcass in just one movement

The door stays in any set position allowing the user to reach the door handle easily

The Lift & Swing mechanism is available for cabinet heights from 450mm to 800mm, and cabinet lengths from 600mm to 1200mm wide

The Lift & Swing mechanisms are available for cabinet with door weights from 4.0kg to 14.5kg

The Lift & Swing mechanism can be adjusted three dimensionally

Minimum depth of cabinet required 280mm

When calculating the door weight please include the handle

450mm Doors

UST 3680-110-06 5.8-7.3kg

UST 3680-111-06 4.8-5.7kg

720mm High

UST 3680-120-06 5.8-7.3kg

UST 3680-121-06 6.3-7.8kg

UST 3680-122-06 7.9-9.3kg

UST 3680-123-06 9.5-12.0kg

Fixing Brackets

UST 3679-000-61 Pairs

Stabilising Rod

UST 3679-113-06 1200mm

UST 3679-537-06 600mm

UST 3679-837-06 900mm

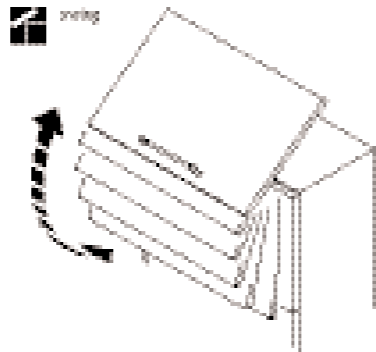
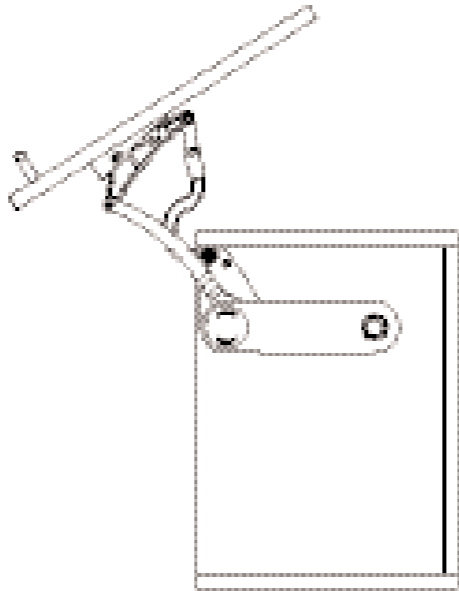

Maxi Stay

The Maxi Stay allows for a smooth and effortless opening of the heaviest doors

The door stays in any set position allowing the user to reach the door handle easily

Can be easily adjusted for any door weight

There is a Maxi Stay to suit 3 door opening angles and 8 door heights

For door widths of 600mm or more, we recommend 2 stays are used to ensure door opens evenly

IMPORTANT NOTE:

For all opening angles, the positioning of the door fixing brackets might be subject to the variation in function of the top hinges and type of frame being used. The setting and function of the lid stay have to be tested individually

UST 3669-000-61 Nickel "A" Type

UST 3669-001-61 Nickel "B" Type

UST 3669-002-61 Nickel "C" Type

UST 3669-003-61 Nickel "D" Type

Screw Size – 4mm Csk

	A	B	C	D
300	3.8 - 7.1	6.7 - 13.7	11.9 - 21.0	15.4 - 27.3
400	2.8 - 5.3	5.0 - 10.3	8.9 - 15.8	11.6 - 20.5
500	2.3 - 4.3	4.1 - 8.3	7.2 - 12.5	9.4 - 16.2
600	1.9 - 3.5	3.3 - 7.0	5.9 - 10.6	7.6 - 13.7
700	1.6 - 3.0	2.8 - 5.7	5.0 - 8.8	6.5 - 11.4
800	1.4 - 2.7	2.5 - 5.1	4.4 - 7.9	5.7 - 10.4
900	1.3 - 2.4	2.2 - 4.6	4.0 - 7.0	5.2 - 9.1
1000	1.1 - 2.1	2.0 - 4.1	3.6 - 6.3	4.6 - 8.2

	A	B	C	D
300	3.0 - 5.3	5.1 - 10.2	9.1 - 15.8	11.9 - 20.8
400	2.3 - 4.0	3.8 - 7.6	6.9 - 11.9	8.9 - 15.6
500	1.8 - 3.2	3.1 - 6.1	5.5 - 9.6	7.2 - 12.5
600	1.5 - 2.7	2.6 - 5.1	4.6 - 7.9	6.0 - 10.4
700	1.3 - 2.2	2.1 - 4.2	3.8 - 6.6	4.9 - 8.7
800	1.1 - 2.0	1.9 - 3.9	3.4 - 5.9	4.4 - 7.8
900	1.0 - 1.8	1.7 - 3.4	3.0 - 5.2	3.9 - 6.9
1000	0.9 - 1.6	1.5 - 3.0	2.7 - 4.7	3.6 - 6.2

	A	B	C	D
300	2.4 - 4.0	3.9 - 7.5	6.8 - 11.6	9.2 - 15.0
400	1.8 - 3.0	2.9 - 5.6	5.1 - 8.7	6.9 - 11.2
500	1.4 - 2.4	2.4 - 4.5	4.0 - 7.1	5.7 - 9.0
600	1.2 - 2.0	1.9 - 3.8	3.3 - 5.9	4.5 - 7.6
700	1.0 - 1.7	1.7 - 3.1	2.9 - 4.8	3.8 - 6.2
800	0.9 - 1.4	1.4 - 2.8	2.6 - 4.3	3.4 - 5.6
900	0.8 - 1.3	1.3 - 2.5	2.3 - 3.8	3.0 - 5.0
1000	0.7 - 1.2	1.1 - 2.2	2.0 - 3.5	2.7 - 4.5

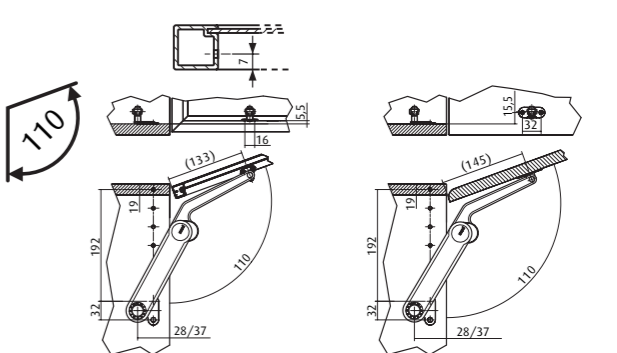
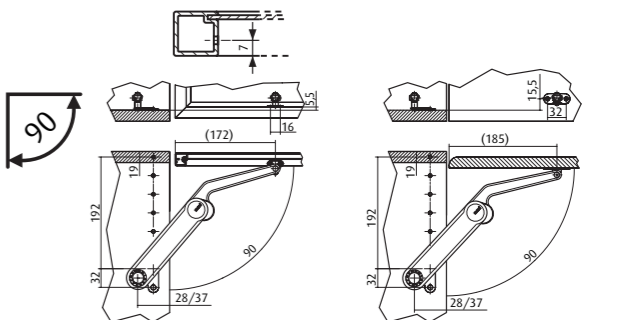
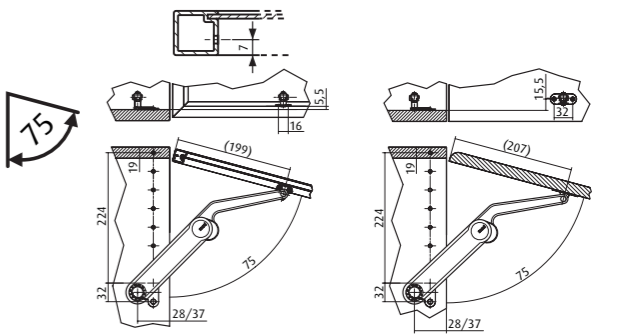

Duo Stay

Duo Stay can be used as a lid stay or as a drop down flap stay

Two weight versions are available; the Duo for weights up to 6kg and the Forte for weights up to 8kg

Easily adjustable from 0kg to maximum capacity by using an allen key

Suitable for wooden and aluminium framed doors by using different brackets

The instant grip action of the stays braking mechanism does not allow sagging when the lid is let go by the user

Duo

Brackets for Wood
UST 3667-010-61 Nickel

Brackets for Aluminium
UST 3667-011-61 Nickel

Forte

UST 3666-010-61 Brackets for Wood

Screw Size – 3mm Csk & 4mm Csk



Flap Stay Braked

Braked flap support stay with adjustable braking force and magnet to hold the door closed

Suitable for cabinets 380mm high

SST 8520-000-05 Brown/Nickel RH
SST 8520-002-05 Brown/Nickel LH

Screw Size – 3mm Csk

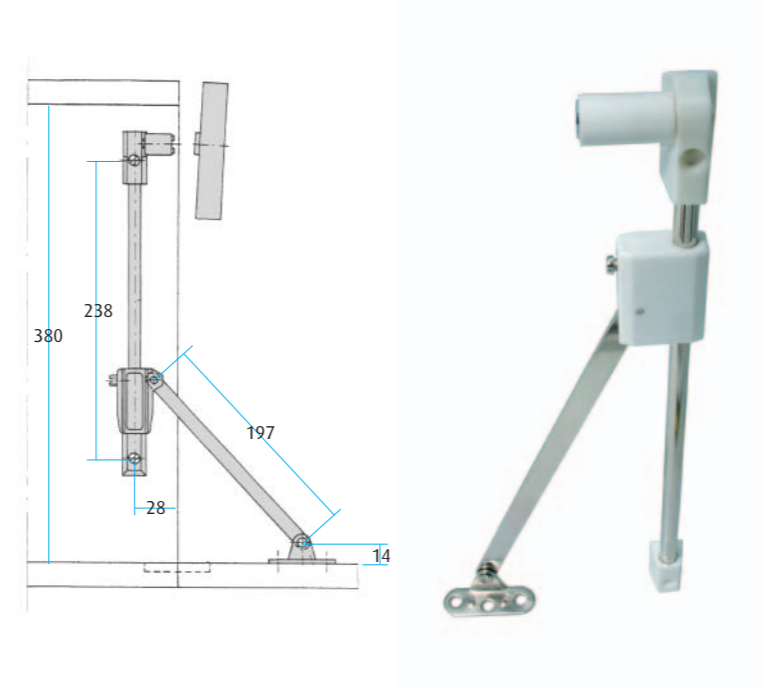

Flap Stay Braked

Braked flap support stay with adjustable braking force

Suitable for cabinets 360mm high

SST 8520-000-04 White/Nickel RH
SST 8520-001-04 White/Nickel LH

Screw Size – 3mm Csk

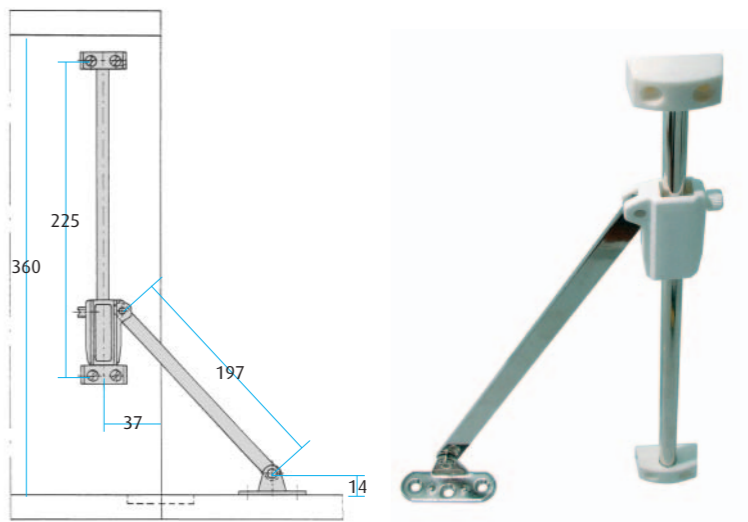

Flap Stay Braked

Braked flap support stay with adjustable braking force

Suitable for cabinet internal height 220mm and cabinet depth of 200mm

SST 8420-000-04 White/Nickel RH

Screw Size – 3mm Csk

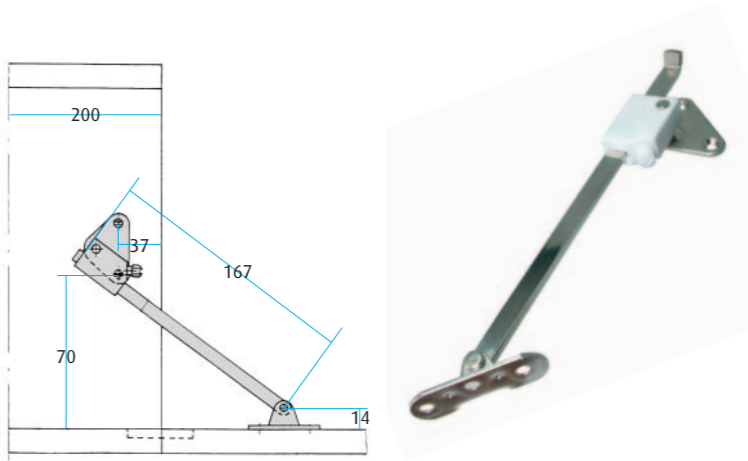

Flap Stay Braked

Friction stay with non adjustable braking 250mm arm

Other size and colours available to special order

SST 8325-000-05 Brown/Nickel

Screw Size – 2.5mm Csk

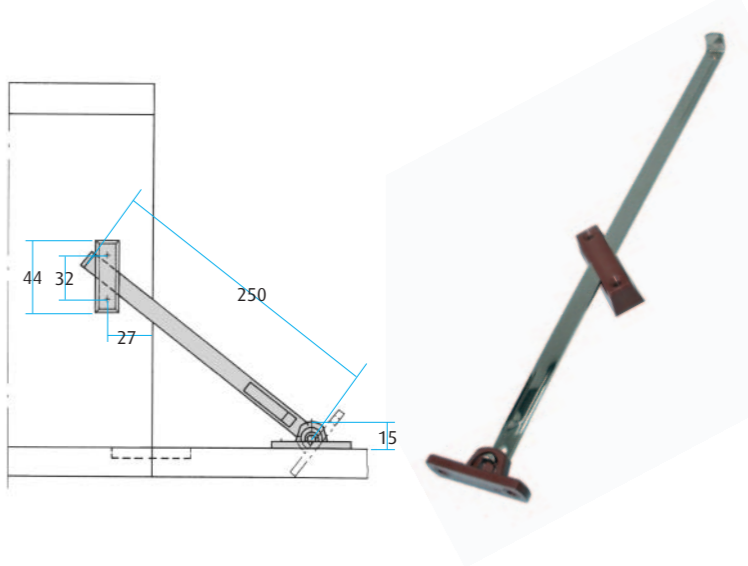

Flap Stay Braked

Braked flap support stay with adjustable braking force
Suitable for cabinet internal height 460mm
Hole centres 332mm

SST 3645-000-42 Bronze RH
SST 3645-001-42 Bronze LH

Braked flap support stay with adjustable braking force
Suitable for cabinet internal height 365mm
Hole centres 262mm

SST 3645-002-42 Bronze RH
SST 3645-003-42 Bronze LH
SST 3645-004-61 Nickel RH

End Brackets to suit above stays

SST 3645-100-03 Black
SST 3645-100-42 Bronze
SST 3645-100-61 Nickel

Screw Size – 3.5mm Arm – 2.5mm Bracket

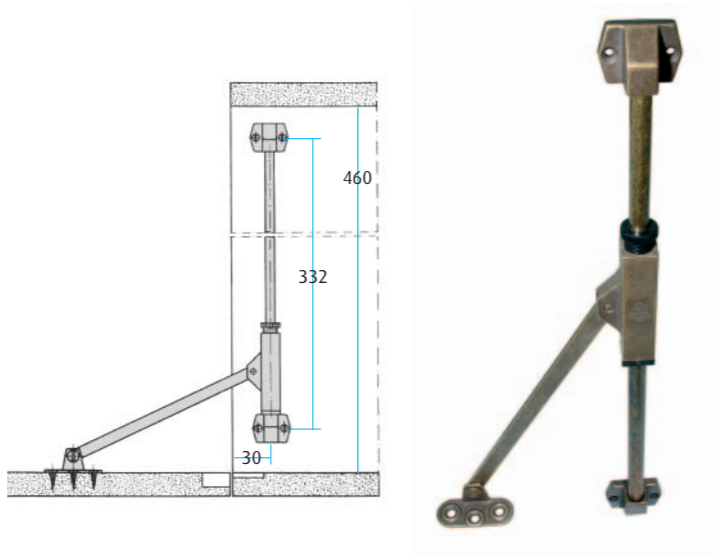

Flap Stay

High quality Stay
Nylon slider for silent foldaway action
The arm does not swing in an arc

178mm (7") Arm Size
184mm (7 1/4") Bar

UST 0577-000-23 Polished Brass

228mm (9") Arm Size
184mm (10 1/2") Bar

UST 0577-001-23 Polished Brass

292mm (11 1/2") Arm Size
327mm (12 7/8") Bar

UST 0577-002-23 Polished Brass

Screw Size – 3.5mm Csk – 3.5mm Pan



Flap Stay

Arm slides through Nylon slider
for silent controlled movement

215mm (8") Arm

UST 0574-000-23 Polished Brass

254mm (10") Arm

UST 0574-001-23 Polished Brass

Screw Size – 3mm Csk – 3mm Pan



Flap Stay

250mm Arm Size
With Bracket

UST 0533-000-05 Brown/Nickel RH
UST 0533-001-05 Brown/Nickel LH
UST 0533-001-04 White/Nickel LH

With Peg fitting

SST 3642-047-03 Black/Nickel RH
SST 3642-048-03 Black/Nickel LH

Screw Size – 3mm Csk



Flap Stay

216mm Overall
225 x 11mm Bar Size

SST 0286-085-61 Nickel

Screw Size – 3mm Csk



Flap Stay Friction

150mm (6") Overall
154 x 9mm Bar Size

SST 0450-006-20 Brass

Screw Size – 3mm Csk



Flap Stay Locking

Variable Tension
216mm (8 1/2") Overall
216 x 19mm Bar Size

SST 0186-000-20 Brass
SST 0186-000-40 Bronze

Screw Size – 2.5mm Csk



Flap Stay

Non Locking
216mm (8 1/2") Overall
178 x 19mm Bar Size
SST 0186-100-20 Brassed
SST 0186-100-40 Bronze
Screw Size – 2.5mm Csk



Flap Stay Locking

Variable Tension
254mm (10") Overall
254 x 19mm Bar Size Straight
SST 0259-010-20 Brassed
Screw Size – 2.5mm Csk



Flap Stay Plastic

224 X 5mm Length Overall
SST 0504-000-04 White
Screw Size – 2.5mm Csk



Door Stay

178mm (7") Overall
168 x 17mm Bar Size
SST 0105-007-20 Brassed
Screw Size – 3mm Csk



Flap Stay Lift Up

150mm (6") Overall
154 x 9mm Bar Size
Comes with plastic disc in white or brown
SST 0350-000-61 Nickel
SST 0350-000-20 Brassed
Screw Size – 3mm Csk



Flap Stay Lift Up

To open lift flap to horizontal
To close flap lift then lower
200mm (8") Overall
200 x 10mm Bar Size
UST 0575-000-61 White/Nickel RH
UST 0575-001-61 White/Nickel LH
Screw Size – 3mm Csk



Cam Action Lid Stay

To open lift lid to full extent
To close lift lid which will release mechanism then close lid
203mm (8")
UST 0578-001-61 Nickel
254mm (10")
UST 0578-002-40 Bronze
UST 0578-002-61 Nickel
216mm (8 1/2")
UST 0578-100-20 Brassed
Screw Size – 3mm Csk



Lid Stay Large

SST 0157-000-40 Bronze RH
SST 0157-001-40 Bronze LH
Screw Size – 3mm Csk



Joint Stay

102mm (4") Each Arm

SST 0602-000-23 Polished Brass RH

SST 0602-001-23 Polished Brass LH

76mm (3") Each Arm

SST 0602-003-23 Polished Brass LH

Screw Size – 3mm Csk



Joint Stay

92 x 8mm Each arm

SST 0177-000-20 Brassd RH

SST 0177-001-20 Brassd LH

Screw Size – 2.5mm Csk



Joint Stay

92 x 8mm Each arm

No Brackets

SST 0177-003-20 Brassd RH

SST 0177-004-20 Brassd LH

Screw Size – 2.5mm Csk



Flap Stay Non-Locking

150mm (6") Overall

192 x 13mm Bar Size

168 x 13mm

SST 0251-000-20 Brassd RH

SST 0251-001-20 Brassd LH

Screw Size – 2.5 Csk



Box Lid Stay

With adjustable friction braking

260mm Arm

SST 3648-110-61 Nickel/Black

SST 3648-001-42 Bronze

Screw Size – 3.5mm Csk Bracket – 3mm Csk Stay

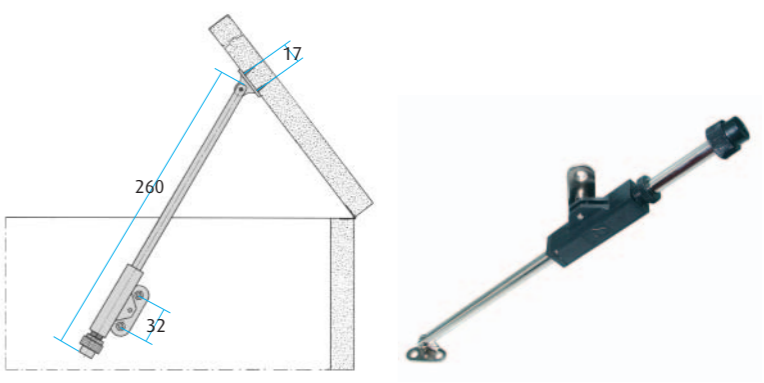

Box Lid Stay

Screw mounted to side panel and lid

Non-handed design

Spring holds lid in position

For heavier lids 2 stays should be used

Distance B should not be less than 85mm

UST 8620-000-04 White

UST 8620-000-03 Black

By selecting screwing dimensions A & B, different lid sizes can be adjusted to an optimum

The weight of the lid is not the relevant measure, but the moment

Moment is calculated as follows:



Lid weight x (0.5 x lid depth) = moment

e.g. (2.5kg x 10 =25N) x (0.5 x 50cm = 20) = 500 Ncm

Weight (1kg=10N)	Size (cm)	Moment (Approx)	A	B	Opening Angle
2.2kgx10=22N	36x0.5=18	22Nx18=400Ncm	13	97	85°
2.5kgx10=25N	40x0.5=20	25Nx20=500Ncm	17	93	85°
3.0kgx10=30N	40x0.5=20	30Nx20=600Ncm	21	89	85°
3.5kgx10=35N	40x0.5=20	35Nx20=700Ncm	25	85	85°
4.0kgx10=40N	40x0.5=20	40Nx20=800Ncm	27	85	80°

Screw Size – 3mm Csk

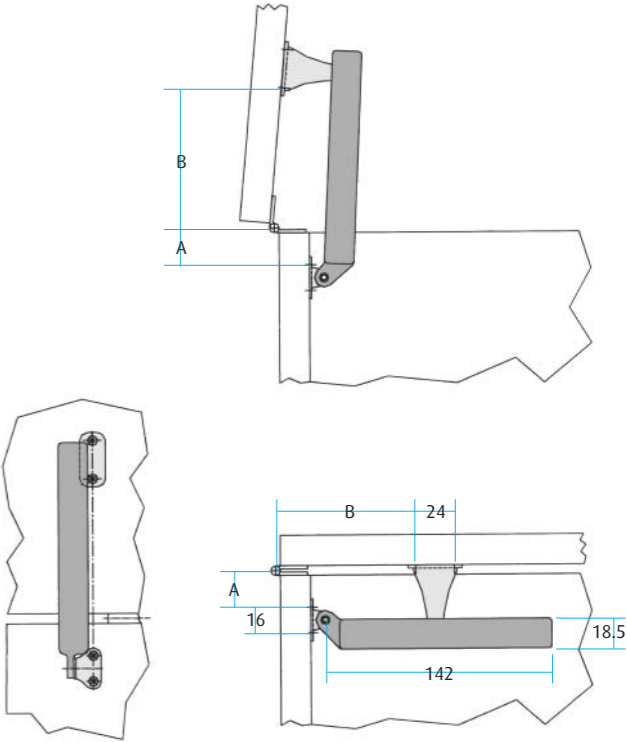
A and B determined by trial positioning



Top Box Flap Stay

This stay can be used without hinges
This slender and compact lid stay takes up minimum amount of space in the cabinet
UST 0600-000-06 Grey
Screw Size – 5mm Pan – 4mm Csk

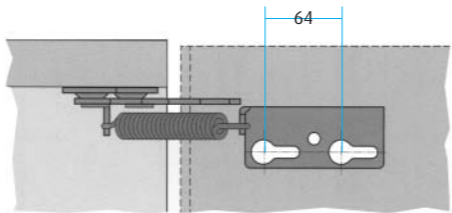
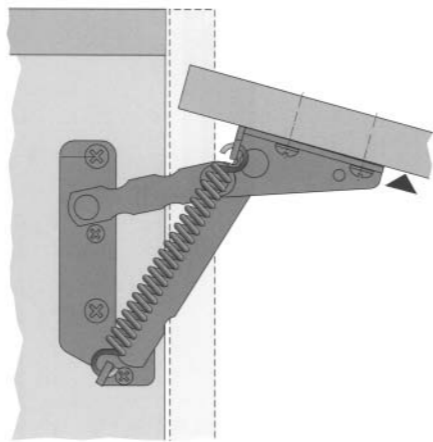
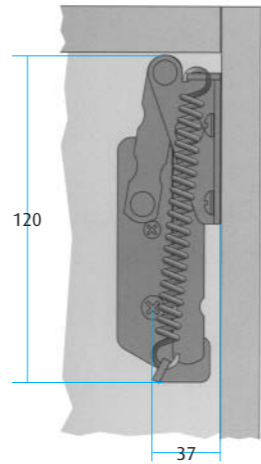

Lid Stay

Hold door closed
Spring action
UST 3610-000-61 Nickel
Screw Size – 3mm Csk

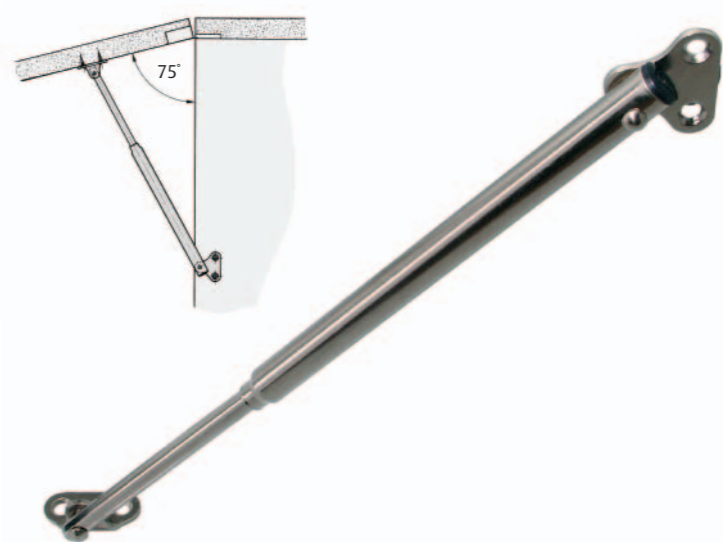

Lid Stay

Suitable for caravans, camper vans and cupboards where a lightweight solution is needed to hold a lid at 90 degrees
SST 3628-001-05 Brown
Screw Size – 3.5mm Csk



Lid Stay

Suitable for a lid up or lid down application
For wall cabinets, chests and cases
For lids up to 2.5kg and lid height of 40cm with 2 lid stays
Opening angle 90 degrees
SST 3616-000-03 Black

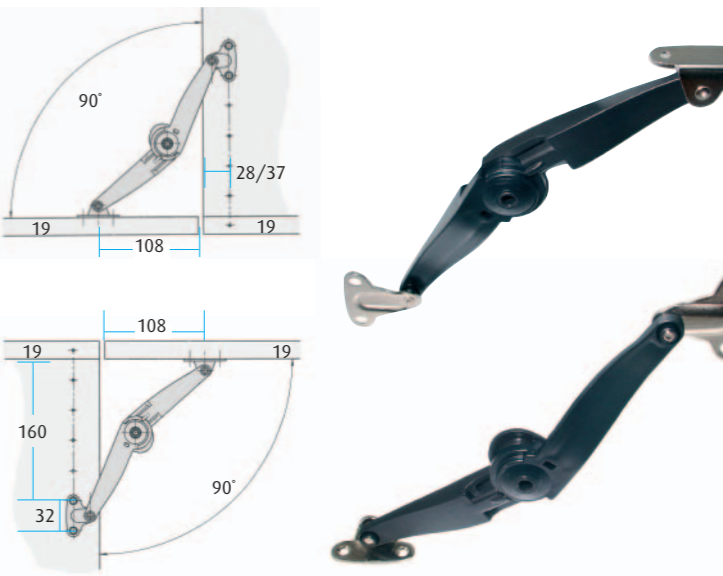

New for 2006

Within the patented HUWILIFT range of fittings, you can now also use the innovative HUWIL technology for overhead kitchen and bathroom cabinets. This is made possible by the compact design and small installation depth. Whether folding, sliding or swinging the new generation of HUWILIFT fittings always provide the optimum solutions.

New perspectives for your products

Forget the limitations of the past! With the latest HUWILIFT range of stays you can now offer your customers completely new solutions. Whilst folding, sliding or swinging mechanisms previously required large cabinet depths, it is now possible to fit the latest HUWILIFT range into shallow cupboards.

The advantages of the new generation of door and flap mechanisms in a nutshell:

- Modular principles: All three versions have the same basic construction
- Suitable for a wide range of door and flap weights
- Time saving through fast and simple installation and adjustment
- Only one basic fitting for all furniture items
- Flexible installation and stocking of fittings

Huwilift "Senso"

A range of fittings for the space saving folding of door lids

- Compact design and small installation depth
- Door fronts without handles are possible
- Integrated damping mechanism in the housing
- Can be used on a wide range of door weights
- Universal lifting arms and fittings can be used on right or left hand sides
- No need to stock or match pairs of arms and fittings
- Suitable for fitting in small bathroom cupboards
- Minimum cabinet depth 135mm
- Very smooth operation
- Ergonomic sequence of motions
- Simple adjustment for different weight doors
- Secure support for the flap in any position
- Users can adjust the door to their individual operating height
- Ideally suited for individual solutions

Not restricted to one hinge, use your existing hinges, as this system can be used with any manufacturers 90,95 and 110 degree hinge

A few standard sizes are:

- 600mm 23kg maximum weight
- 720mm 20kg maximum weight
- 800mm 17kg maximum weight

Special sizes can be requested subject to further discussions on door sizes, weights and quantities required



Huwilift “Strato”

A range of mechanisms for sliding doors upwards and parallel

- Compact design and small installation depth
- Particularly suited for small to medium doors
- Simple adjustment to different door weights
- Traverse rod fits directly under cupboard top
- Integrated damping mechanism in the housing
- Suitable for fitting in small bathroom cupboards
- Minimum cabinet depth 135mm
- Very smooth operation
- Ergonomic sequence of motions
- Simple adjustment for different weight doors
- Secure support for the flap in any position
- Users can adjust the door to their individual operating height
- Ideally suited for individual solutions

A few standard sizes are:

- 600mm 23kg maximum weight
- 720mm 20kg maximum weight
- 800mm 17kg maximum weight

Special sizes can be requested subject to further discussions on door sizes, weights and quantities required



Huwilift “Verso”

A range of mechanisms for a smooth and even raising of a door above the cupboard top

- Compact design and small installation depth
- Particularly suited for medium to large doors
- Simple adjustment to different door weights
- Traverse rod fits directly under cupboard top
- Integrated damping mechanism in the housing
- Suitable for fitting in small bathroom cupboards
- Minimum cabinet depth 135mm
- Very smooth operation
- Ergonomic sequence of motions
- Simple adjustment for different weight doors
- Secure support for the flap in any position
- Users can adjust the door to their individual operating height
- Ideally suited for individual solutions

A few standard sizes are:

- 600mm 23kg maximum weight
- 720mm 20kg maximum weight
- 800mm 17kg maximum weight

Special sizes can be requested subject to further discussions on door sizes, weights and quantities required

